

PROPOSED SUB-DIVISION PLAN AT
 NO. 11, 11/PART. IN S.NO 340/50 & PART.
 B OF 158 ZAMU PALLAVARAM,

KAMARAJAR STREET, BHARATHI NAGAR,
 SAIDAPET TQ, CHINGLEPUT DT.,
 PALLAVARAM MUNICIPALITY,
 MADRAS - 430

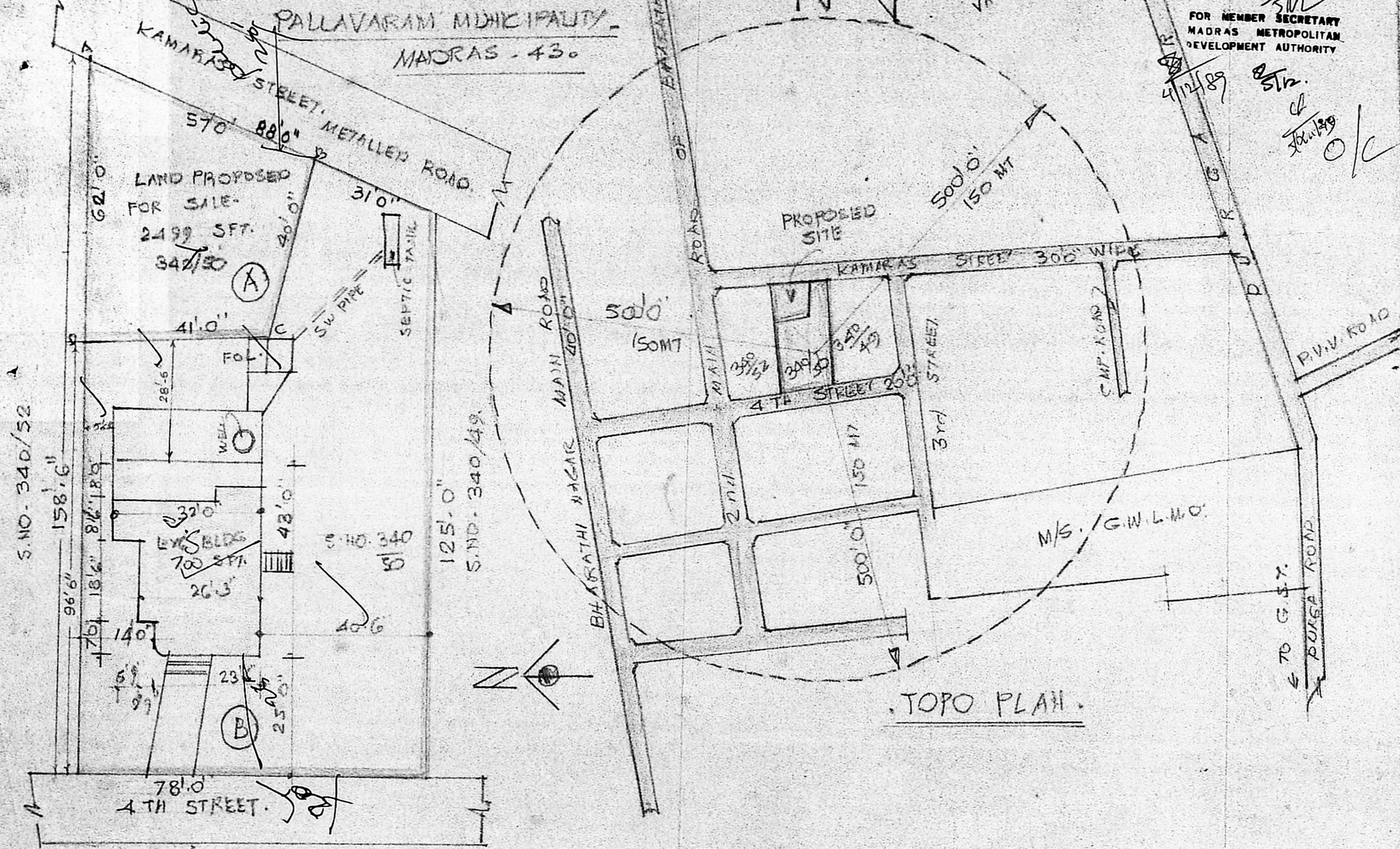

APPROVED
 VIDE Lr. No. D26/16597/89 A
 Dtd. 12-89
 P.P.D. No. 293
 L.O. No. 89
 FOR MEMBER SECRETARY
 MADRAS METROPOLITAN
 DEVELOPMENT AUTHORITY

5971 5970
 59
 PLOT NO. 11 PT. 2499 232.10
 B. PLOT NO. 11. 9266 86.8
 S.NO. 340/50
 11,765 1092.95

COLOUR INDEX
 PROPOSED
 ROAD
 EXG. BUILDING

A. [Signature]
 B. S. [Signature]
 11/5/89

Antonisami
A. A. ANTONISAMI
 CIVIL ENGINEER &
 Licensed Surveyor - Class. 1
 CORPORATION OF MADRAS
 License No. 158
 ENGINEER.

FR
 3/10

SUB-DIVISION PLAN